

PUERTA RESIDENCIAL SERIE 50

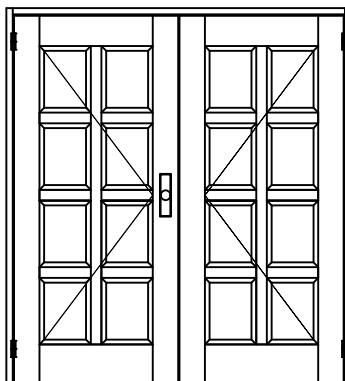
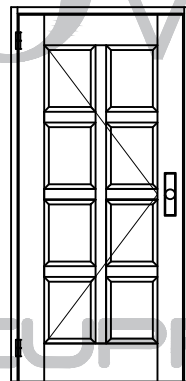
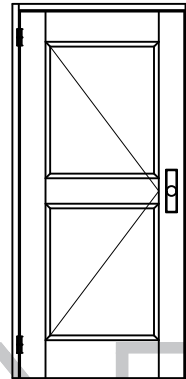
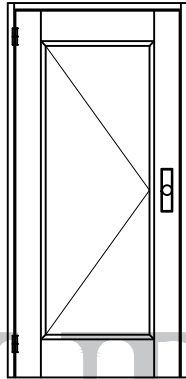

EUROVENT

CLASSIC

CUPRUM



CLASSIC

SERIE

S50



BATIENTE PUERTA

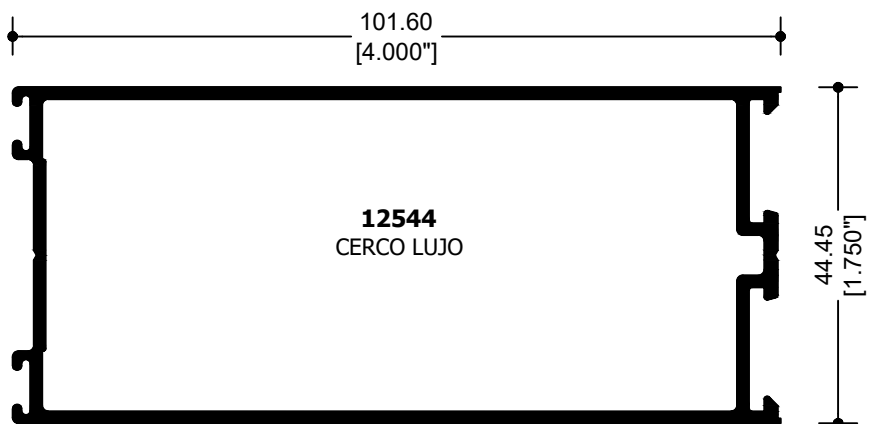

CLASSIC
SERIE

S50

BATIENTE PUERTA

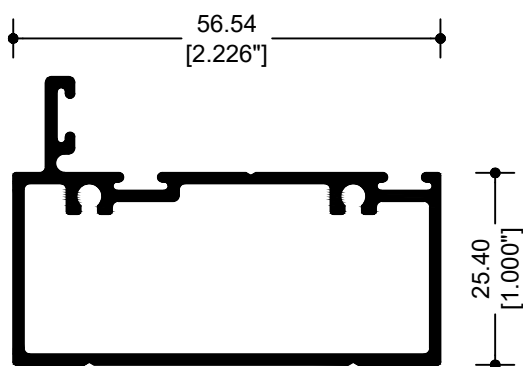
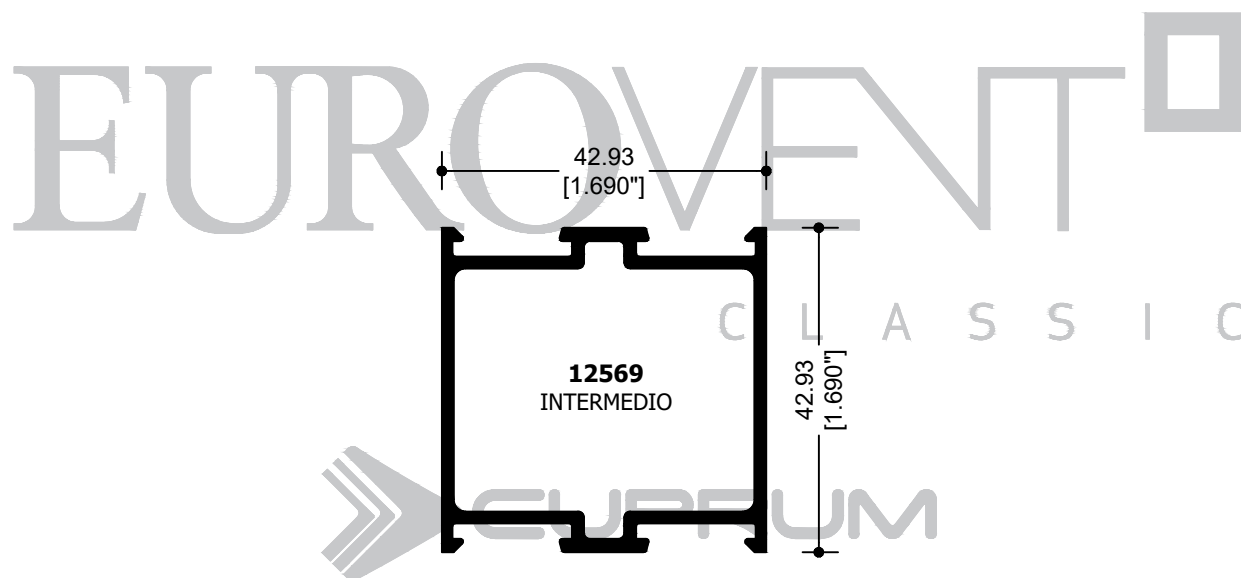

12617
BATIENTE

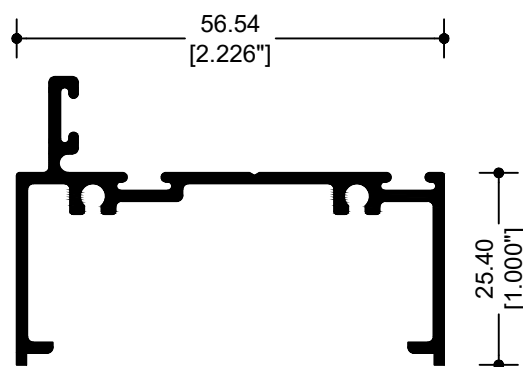

12756
BATIENTE

PUERTA BATIENTE RESIDENCIAL S50 - PERFILES

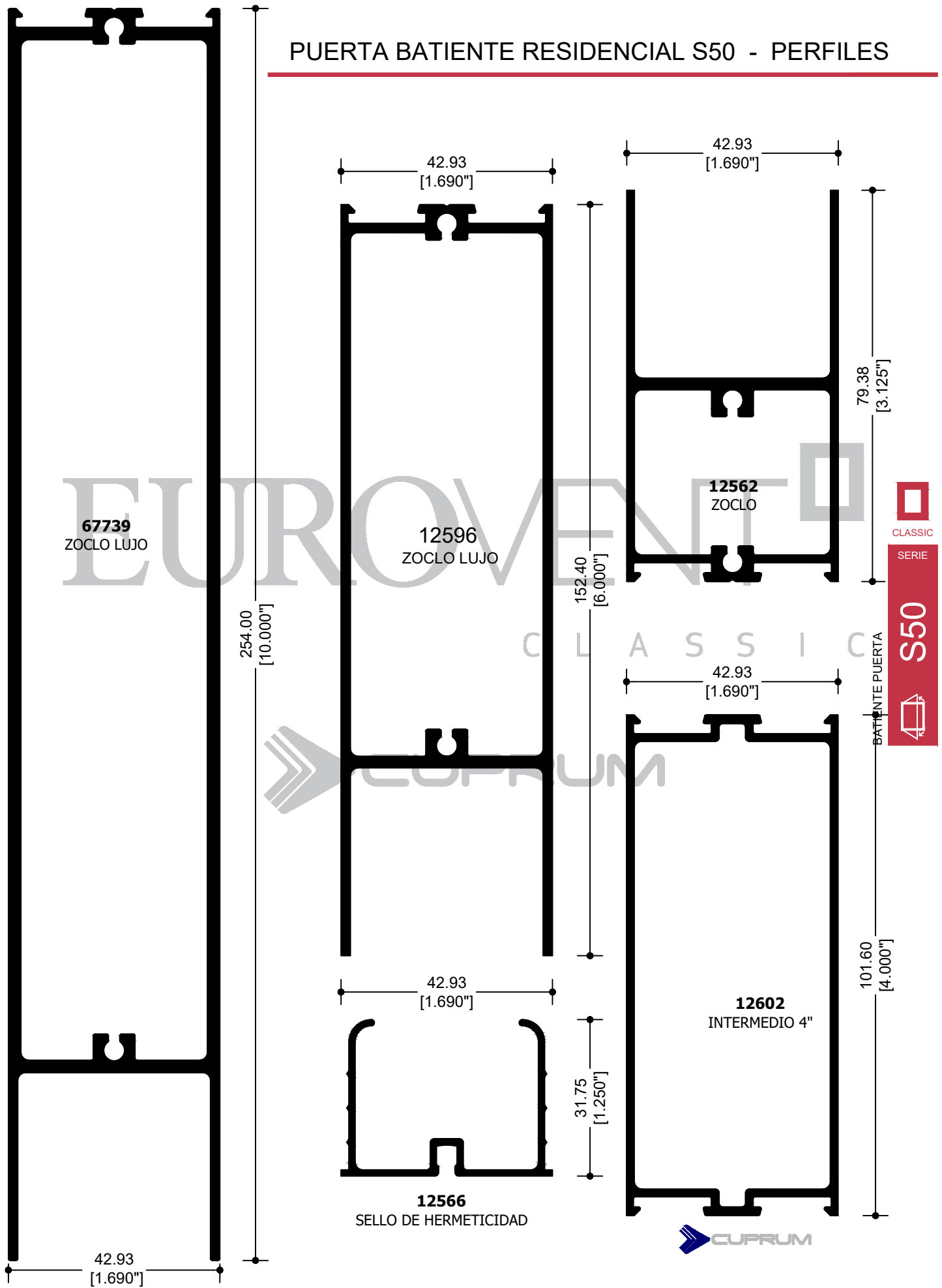

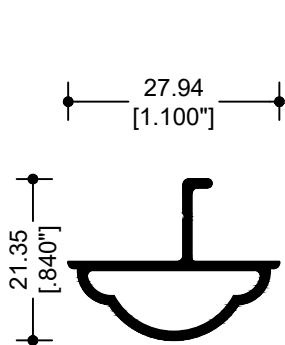

12653
ADAPTADOR INTERMEDIO

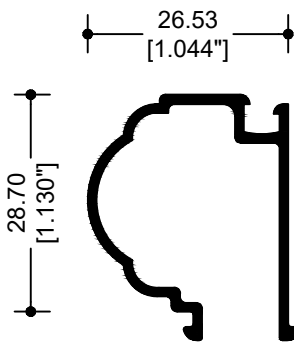

12595
JUNQUILLO ALTO RELIEVE

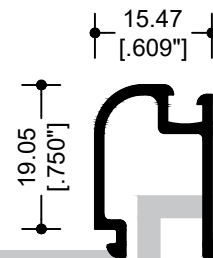

12576
JUNQUILLO COLONIAL

CLASSIC
SERIE

S50



BATIENTE PUERTA

EUROVENT

C L A S S I C

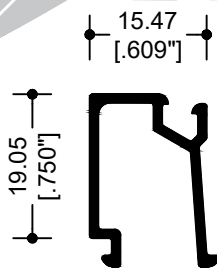

12543
JUNQUILLO

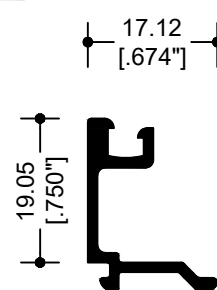

12603
JUNQUILLO DOBLE VIDRIO

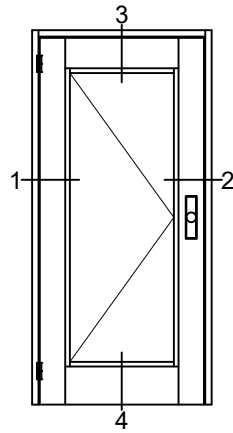

SIN ESCALA

EUROVENT



CLASSIC

SERIE

C L A S S I C

BATIENTE PUERTA

S50



EXTERIOR



CUPRUM

CERRADURA
CON MANIJA

SELLADOR
INTEMPERIE

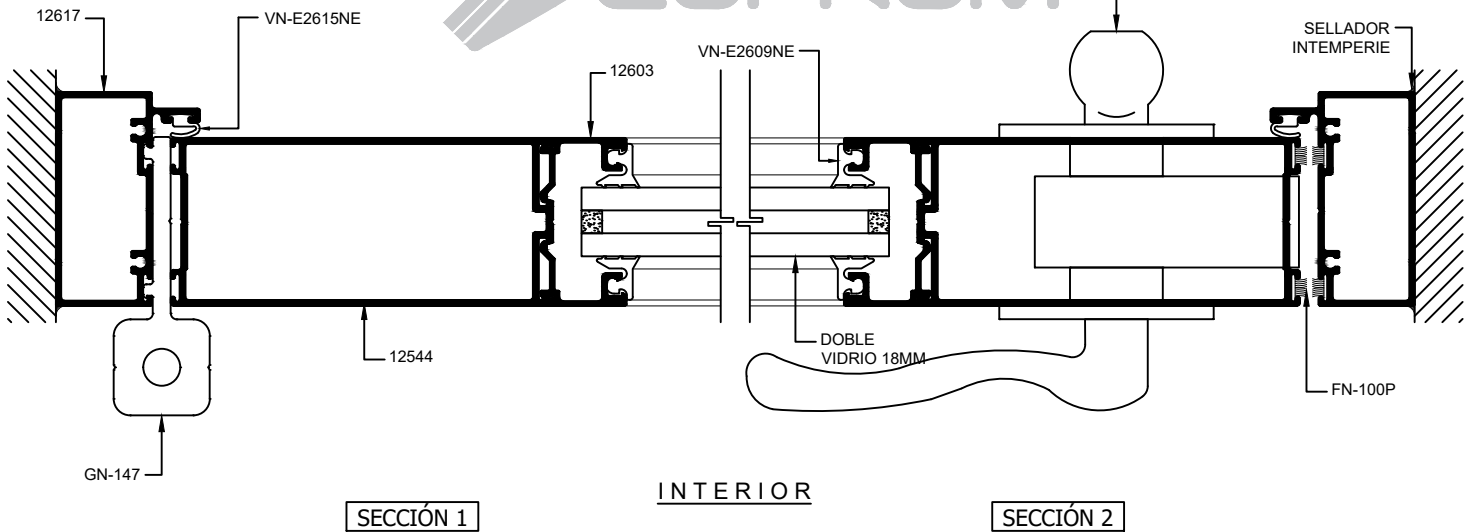

CLASSIC
SERIE
S50
BATIENTE PUERTA

SECCIÓN 3

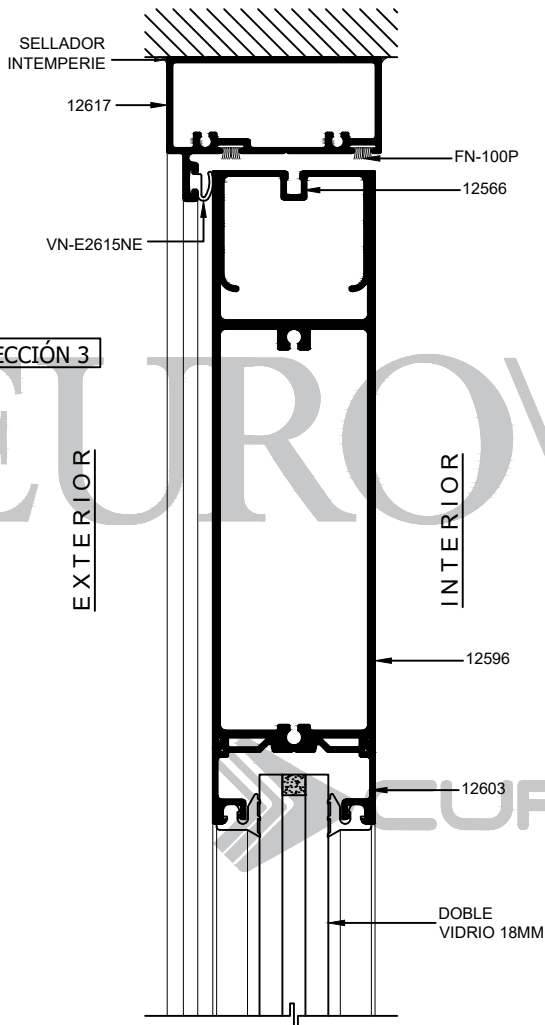

SECCIÓN 4

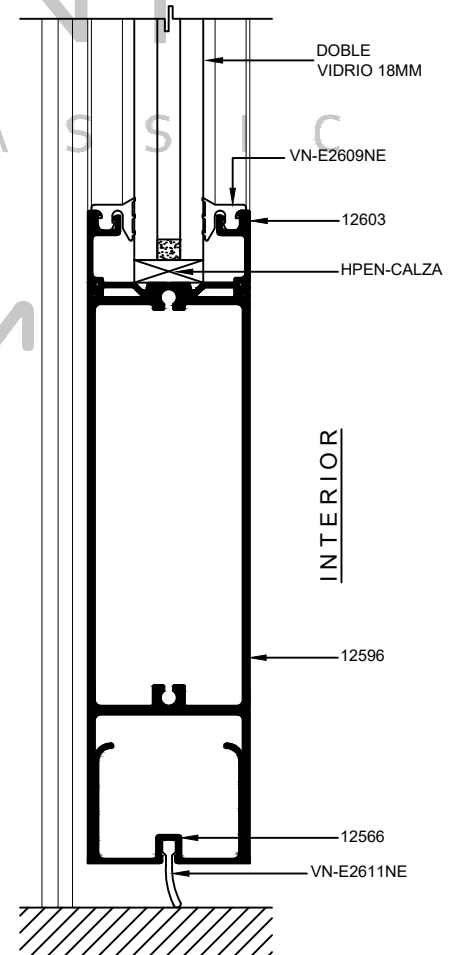

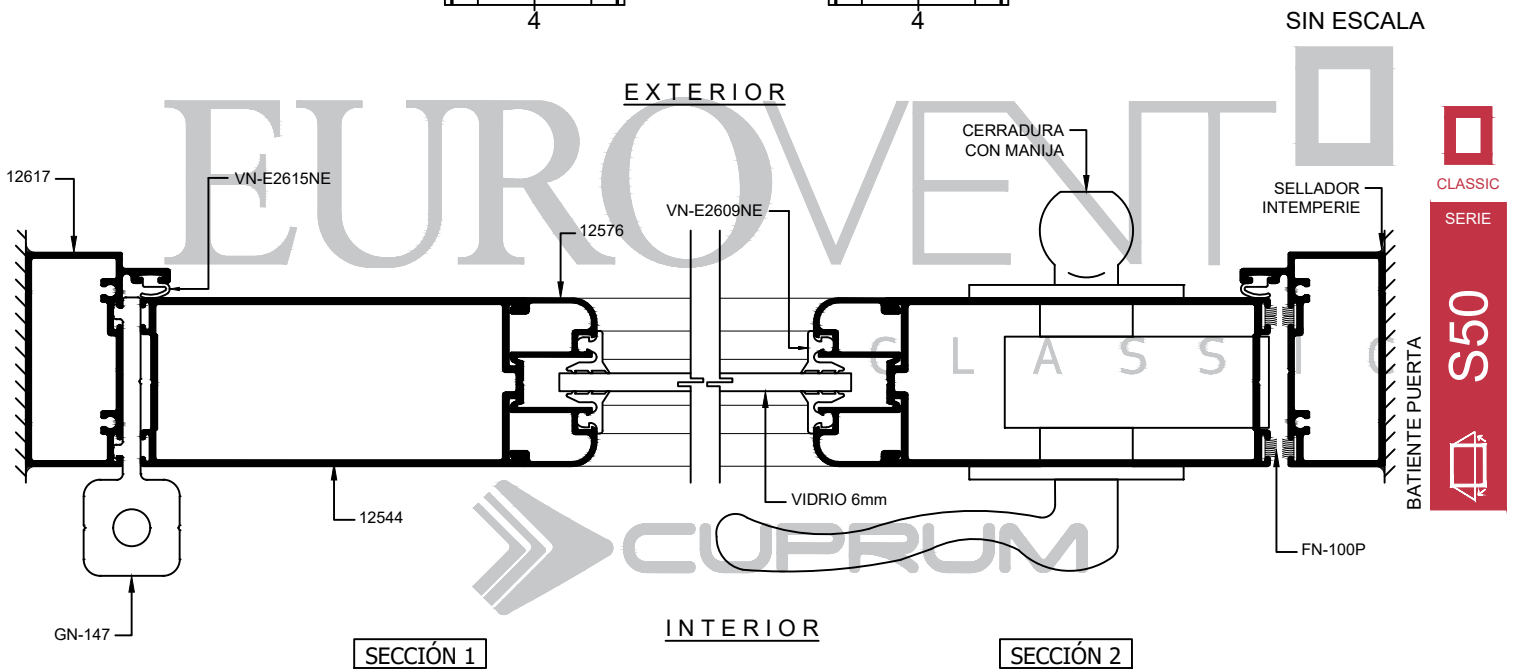
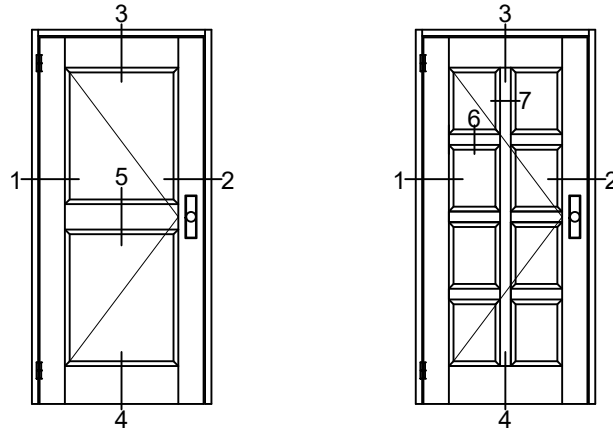

SECCIÓN 1

SECCIÓN 2

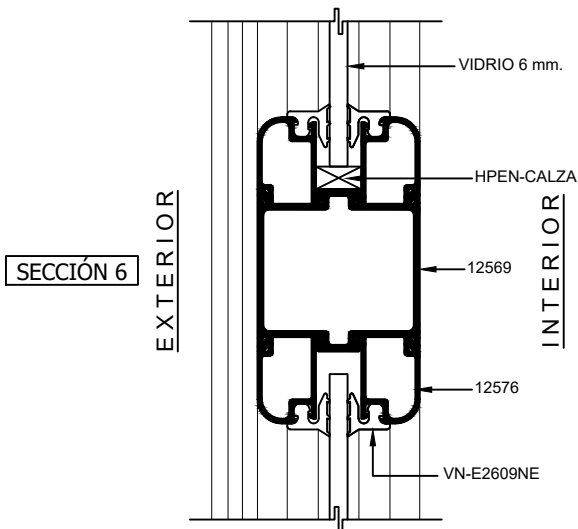

SECCIÓN 6

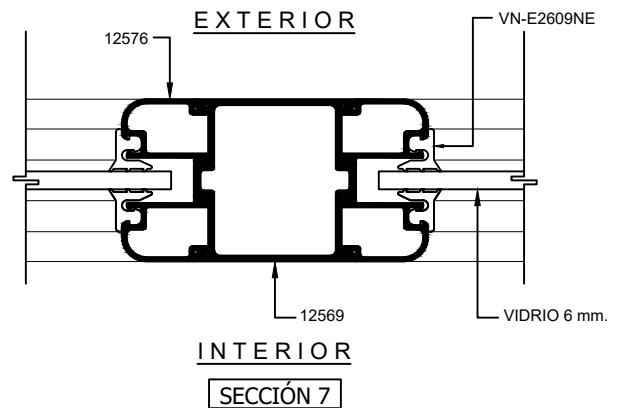

SECCIÓN 7

CLASSIC
SERIE
S50
BATIENTE PUERTA

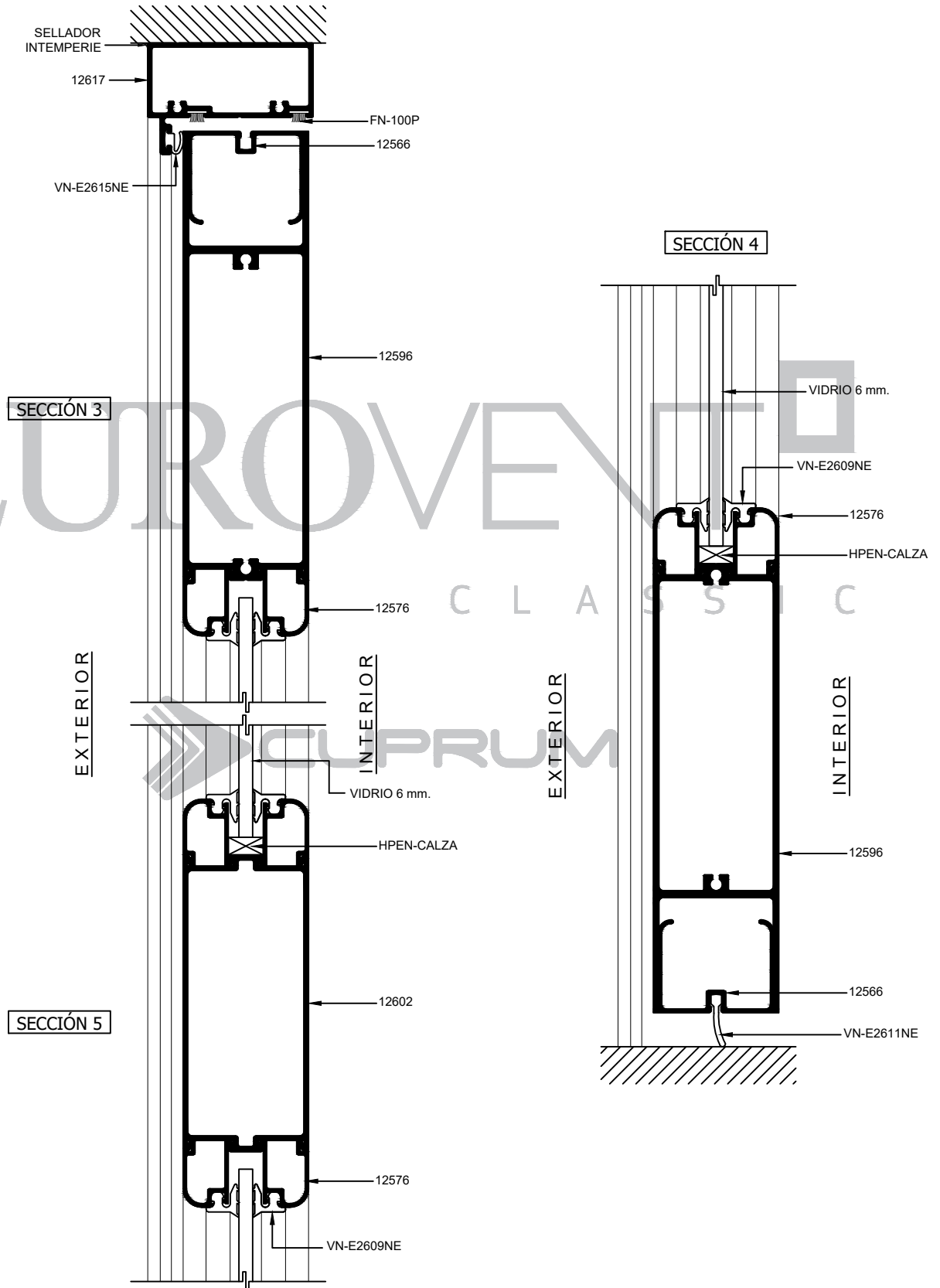

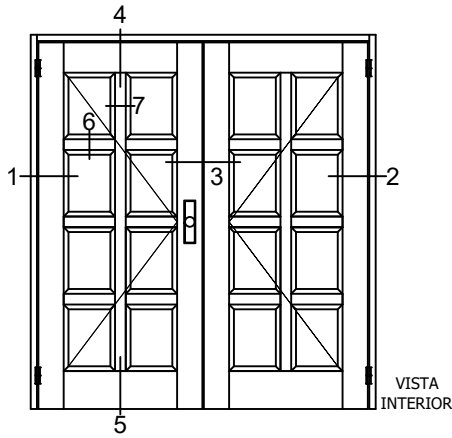

EUROVENT[®] CLASSIC

SECCIÓN 1

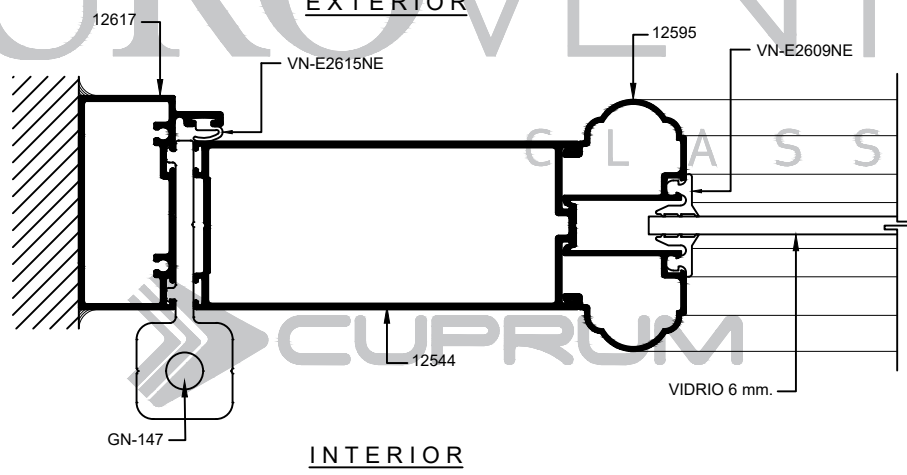

CLASSIC
SERIE
S50
BATIENTE PUERTA

EXTERIOR

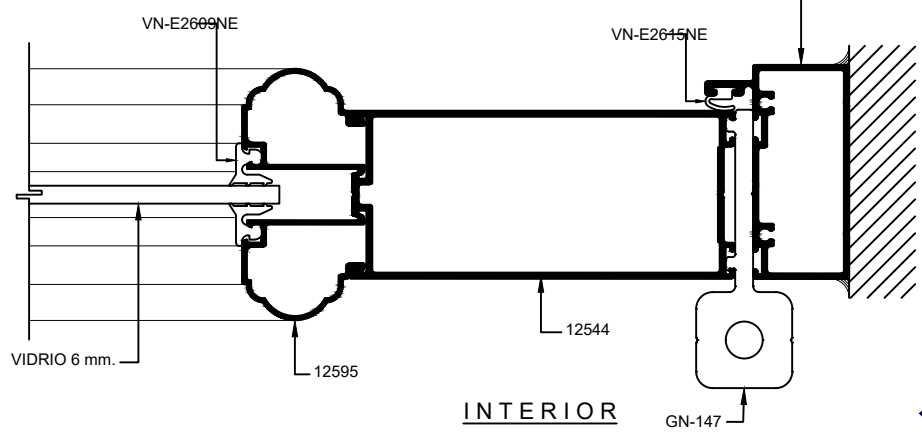

SECCIÓN 2

EXTERIOR

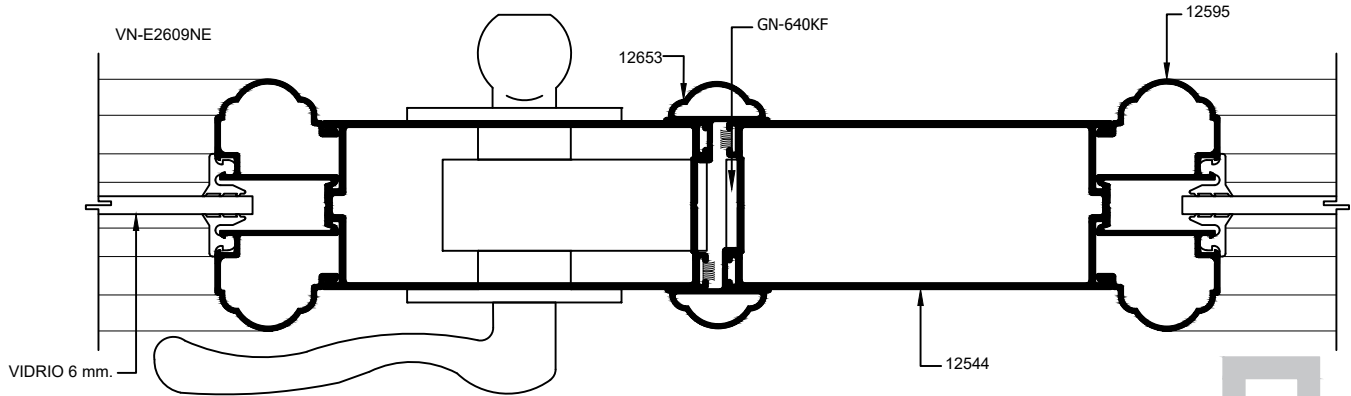

SECCIÓN 3

INTERIOR

CLASSIC
SERIE

S50

BATIENTE PUERTA

EUROVENT[®]
CLASSIC

SECCIÓN 6

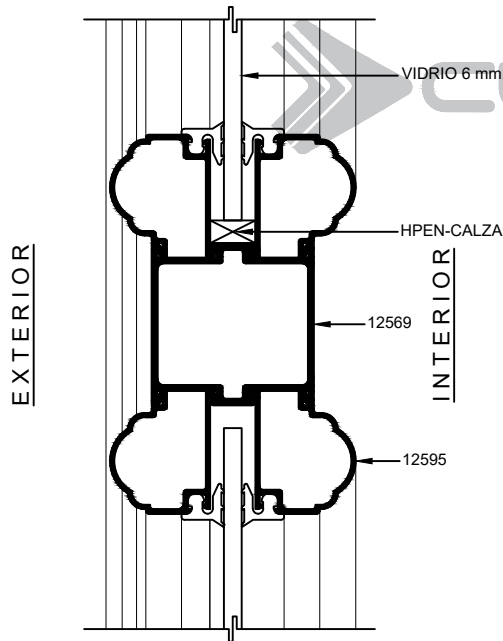

EXTERIOR

INTERIOR

SECCIÓN 7

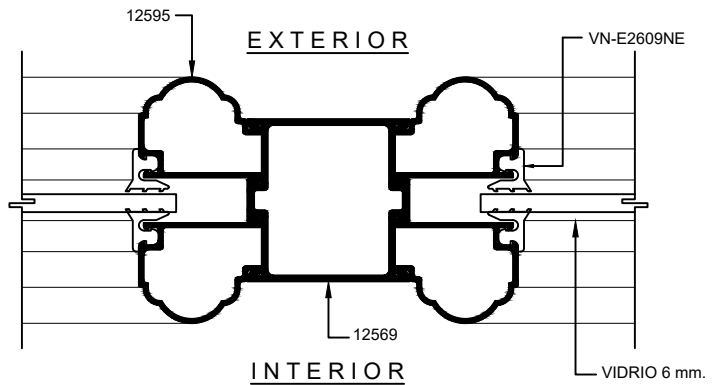

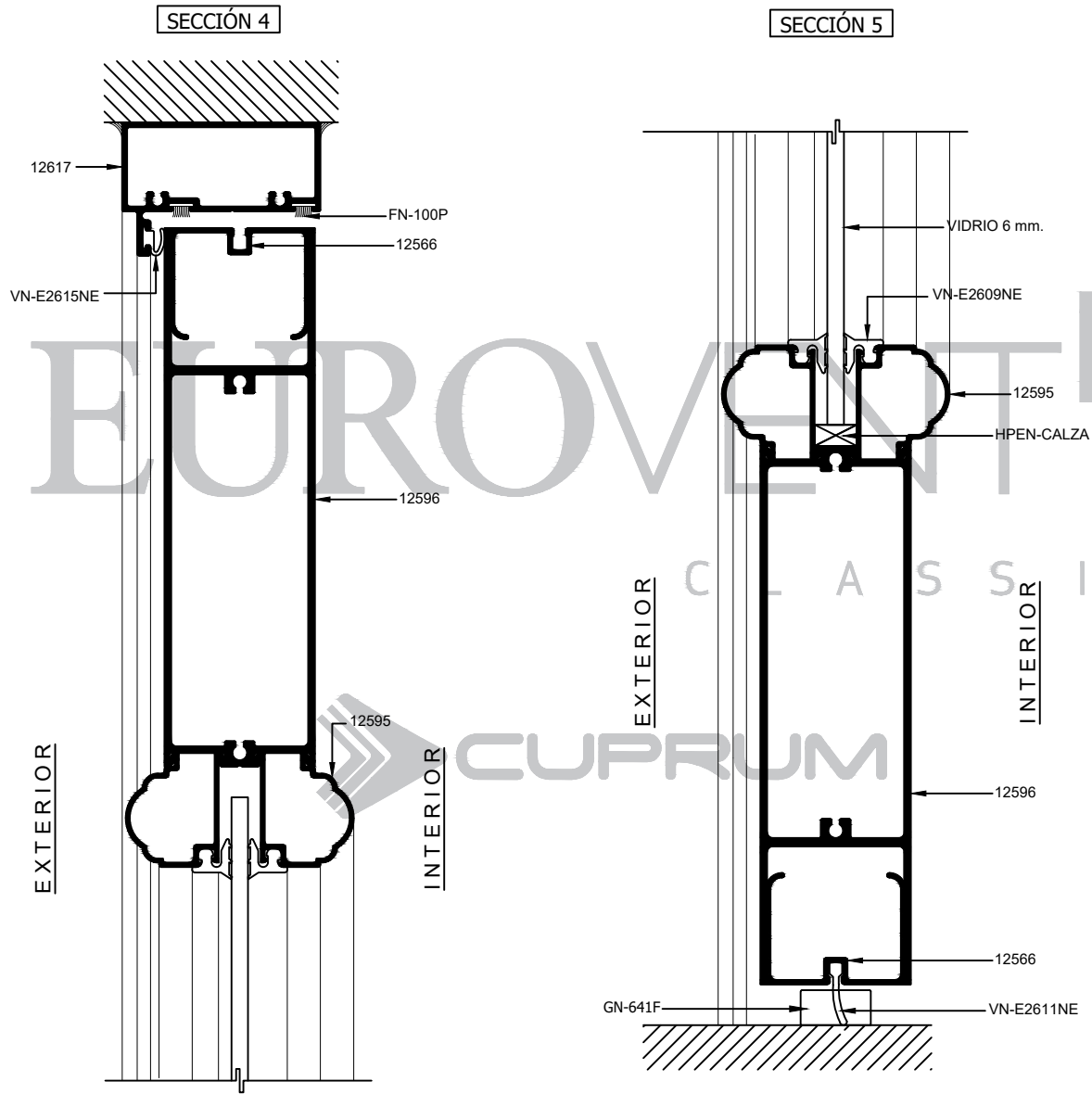

CLASSIC

SERIE

S50



BATIENTE PUERTA

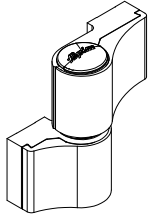

GN-616F
 BISAGRA LOIRA DOS ALAS
 CAPACIDAD DE CARGA:
 CON 2 BISAGRAS 120 KG.
 (CONSIDERANDO LAS DIMENSIONES
 DE 1000 MM. x 2200 MM.)

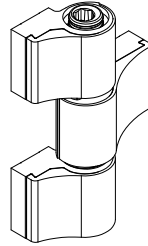

GN-617F
 BISAGRA LOIRA TRES ALAS
 CAPACIDAD DE CARGA:
 CON 2 BISAGRAS 150 Kg.
 (CONSIDERANDO LAS DIMENSIONES
 DE 1000 MM. x 2000 MM.)

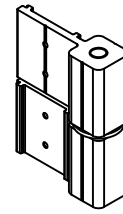

GN-147
 BISAGRA LIBRO
 CAPACIDAD DE CARGA:
 CON 2 BISAGRAS 80 KG.
 CON 3 BISAGRAS 100 KG.
 (CONSIDERANDO LAS DIMENSIONES
 DE 1000 MM. x 2000 MM.)

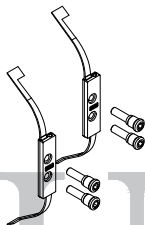

GN-616FC
 CALZO PARA BISAGRA

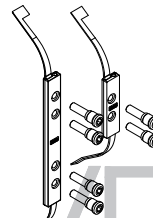

GN-617K
 CALZO PARA BISAGRA

CLASSIC
 SERIE

S50

BATIENTE PUERTA

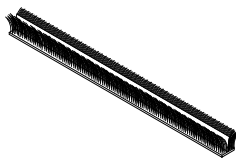

FN-100P
 FELPA CON PLÁSTICO

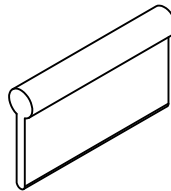

VN-E2611NE
 VINIL ALETA

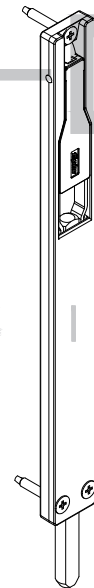

GN-640KF
 PASADOR

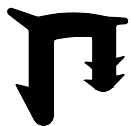

VN-E2609NE
 EMPAQUE BATIENTE



VN-E2615NE
 EMPAQUE BATIENTE

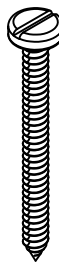

PFNG-0805
 #8x1½"

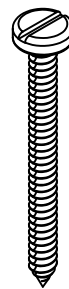

PENG-1017
 #10x1½"

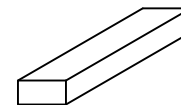

HPEN-CALZA
 CALZA DE 1/4" x 3/8" x 4"



EURO-GN102
 TAPÓN CUBRE PIJA



T2137120
 TENSOR 3/8"



DEFLEXIÓN MAX. L/175

LOS LÍMITES DE FABRICACIÓN PARA LOS PERFILES, SERÁN LOS QUE SE ENCUENTREN DEBAJO DE LAS CURVAS GRAFICADAS.

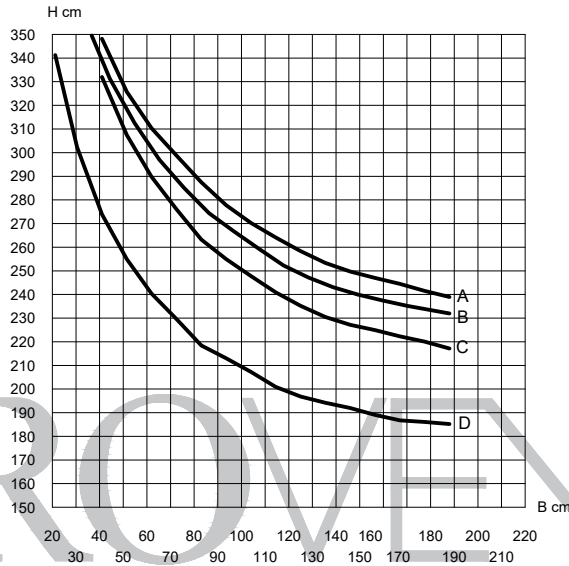

ALEACIÓN: 6063
TEMPLE: 5

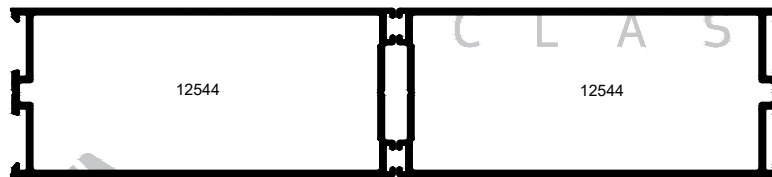

I x-x= 33.94 cm⁴



Valores de presión por velocidad de viento

Curvas	Presión del diseño	Velocidad de viento	Zona
A	45 Kg/m ²	80 Km/h	Centro de grandes ciudades
B	50 Kg/m ²	90 Km/h	Barrios Residenciales
C	65 Kg/m ²	120 Km/h	Campo Abierto
D	110 Kg/m ²	160 Km/h	Zona Costera

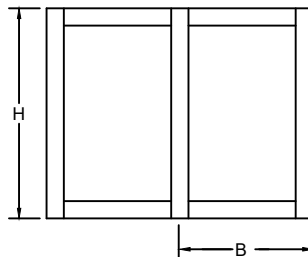

LOS LÍMITES DE UN CANCEL VAN EN FUNCIÓN DE LA COMBINACIÓN DE RESISTENCIA DEL PERFIL DE ALUMINIO, EL VIDRIO Y LOS ACCESORIOS QUE LO INTEGRAN.

VERIFICAR QUE LA DEFLEXIÓN DEL PERFIL SEA COMPATIBLE CON EL VIDRIO UTILIZADO.

CLASSIC
SERIE
S50
BATIENTE PUERTA



TABLA DE DESCUENTOS PUERTA BATIENTE 1 HOJA			
CLAVE	DESCRIPCIÓN	No. DE PIEZAS	CORTE Y DESCUENTO
12617	BATIENTE	1	L-51
12617	BATIENTE	2	H
12544	CERCO DE LUJO	2	H-44
12596	ZOCLO DE LUJO	2	L-268
12569	INTERMEDIO	6	L/2-154
12569	INTERMEDIO	1	H-349
12595	J/ALTO RELIEVE	32	L/2-146
12595	J/ALTO RELIEVE	32	H/4-112
12566	S HERMETICIDAD	2	L-73
VIDRIO		L	L/2-165
		H	H/4-130
L= ANCHO DE VENTANA		DESCUENTOS EN MM.	
H= ALTO DE VENTANA			



PARÁMETROS MÍNIMOS Y MÁXIMOS DE FABRICACIÓN.

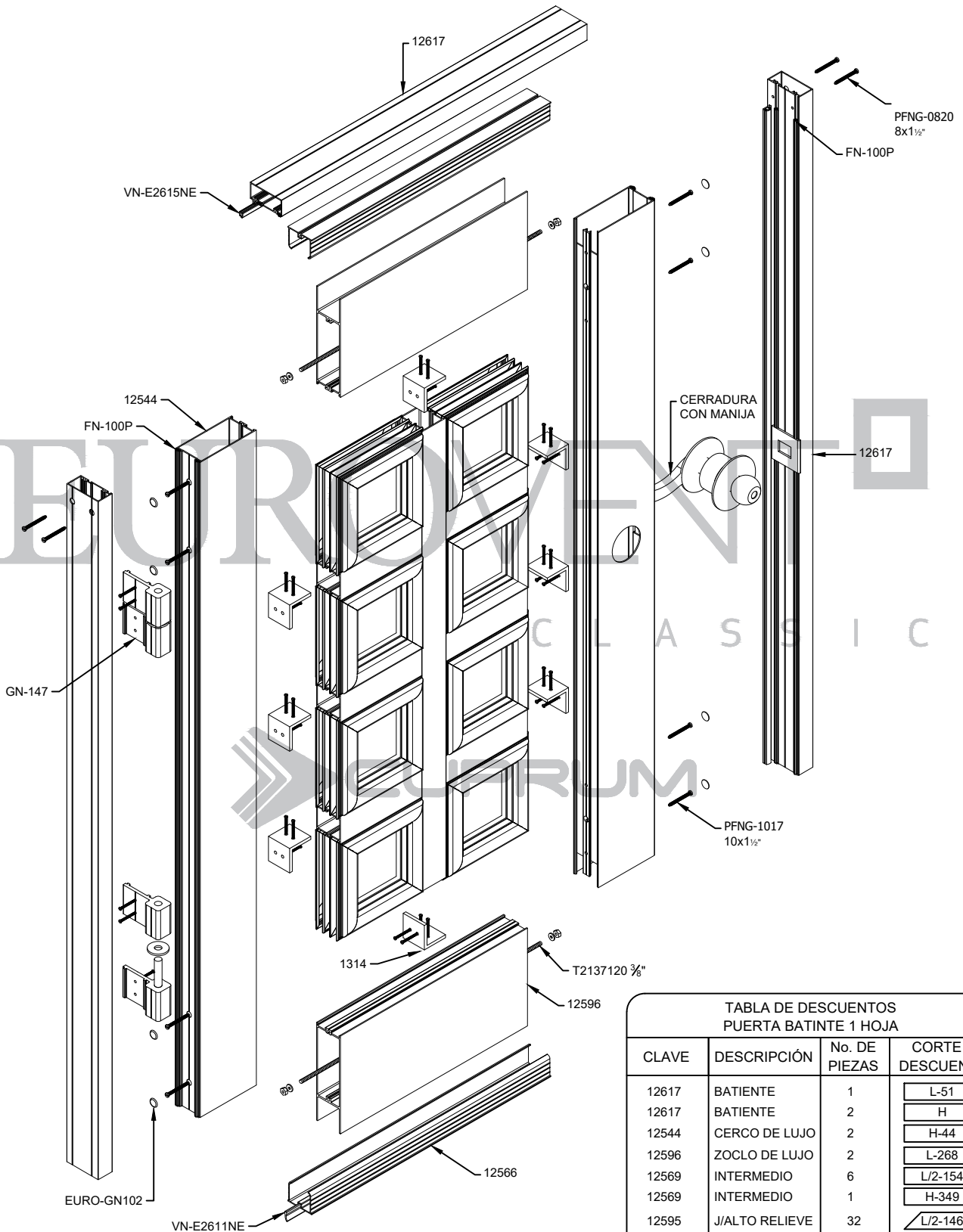
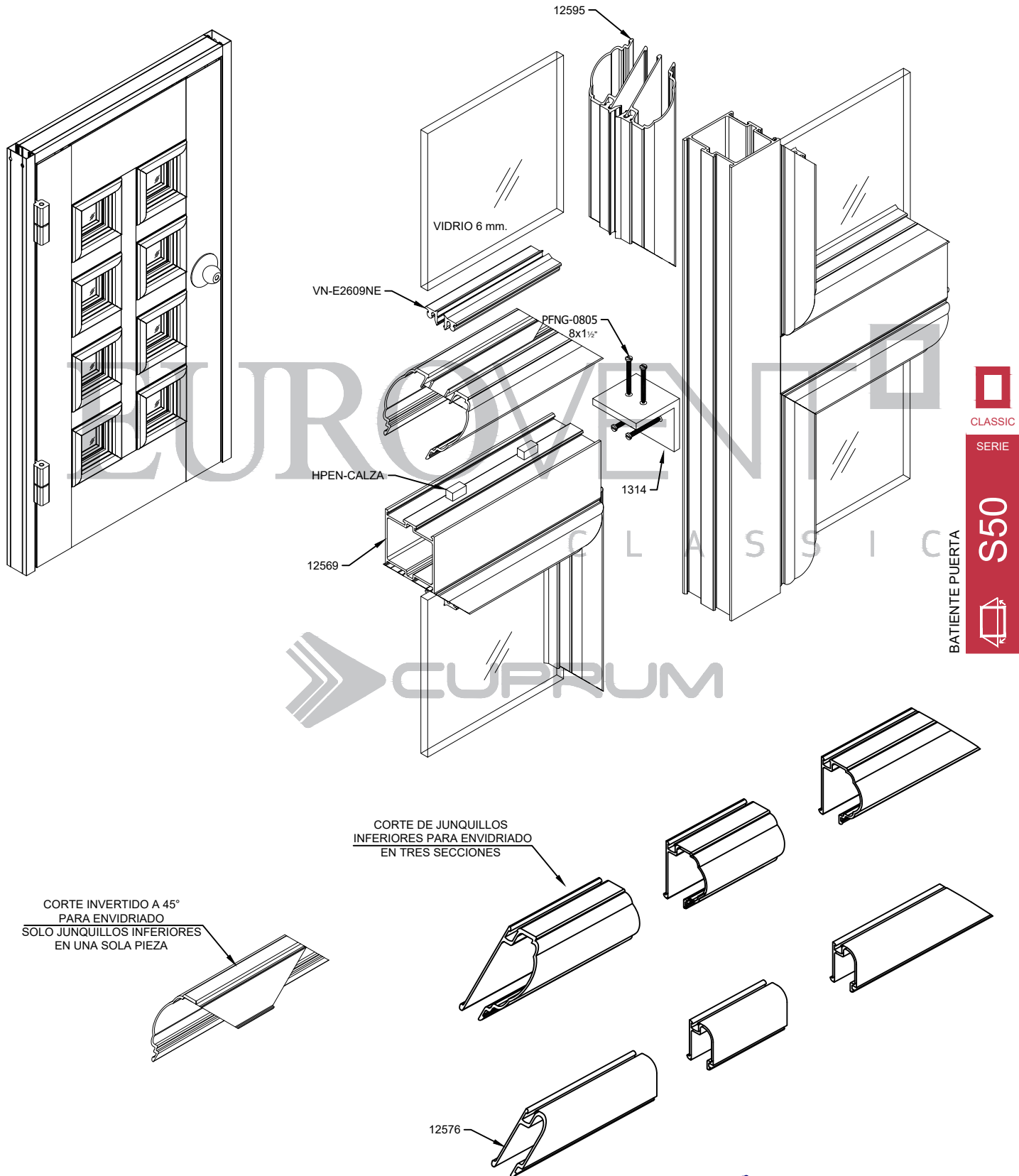
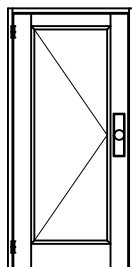

PBR-50
MÍNIMO 0.80 x 1.80
MÁXIMO 1.30 x 2.80

CLASSIC
SERIE

S50



BATIENTE PUERTA

ALUMINIO

CLAVE	DESCRIPCIÓN	PIEZAS X ATADO	LARGO STD. MTS.	PERÍMETRO ANOD. CM.	PERÍMETRO PUL. CM.
12543	JUNQUILLO	20	6.10	13.57	2.95
12544	CERCO LUJO	4	4.60	33.95	27.06
12544	CERCO LUJO	4	6.10	33.95	27.06
12562	ZOCLO	4	5.00	34.34	15.80
12566	SELLO DE HERMETICIDAD	10	6.10	24.35	0.00
12569	INTERMEDIO	4	6.10	21.94	8.58
12576	JUNQUILLO COLONIAL	20	6.10	13.14	2.74
12595	JUNQUILLO ALTO RELIEVE	12	6.10	20.15	5.17
12596	ZOCLO LUJO	2	6.10	48.95	30.86
12602	INTERMEDIO LUJO	3	6.10	33.67	20.32
12603	JUNQUILLO	20	6.10	10.47	2.30
12617	BATIENTE	6	6.10	21.66	16.02
12653	ADAPTADOR INTERMEDIO	20	6.10	9.18	6.88
12756	BATIENTE ABIERTO	8	6.10	30.04	16.25



Este manual esta protegido bajo varias patentes y diseños en tramite.
Prohibida su reproducción total o parcial.